

March 11, 2019

TO: All Bidders under ITB No. 19-101072, ROAD WIDENING, SIDEWALKS, BIKE LANES (ROCKBRIDGE ROAD - ALLGOOD TO ROWLAND ROAD)

FROM: Department of Purchasing and Contracting, DeKalb County, Georgia

ADDENDUM NO. # 1

Invitation to Bid (ITB) No.: 19-101072, ROAD WIDENING, SIDEWALKS, BIKE LANES (ROCKBRIDGE ROAD - ALLGOOD TO ROWLAND ROAD), is hereby amended as follows:

1. We have received questions pertaining to this Invitation to Bid. The questions and their resulting answers appear below:
 - A. **Question:** Who pays for the testing of concrete or general testing? Is it the County or the Contractor?

Answer: The County will be responsible for the testing of the concrete and asphalt during the project. Please note that NPDES monitoring and testing is the responsibility of the Contractor.

- B. **Question:** Any geotechnical exploration or do you have any information on the presence of rock within the project limit?

Answer: No geotechnical exploration/reports were performed during the preconstruction phase of this project.

- C. **Question:** Would you require clearing of all trees within the construction easements?

Answer: The contractor is not required to clear all of the trees within the temporary easements.

- D. **Question:** Does the DBE requirement for 0008121 need to include the W&S items? .

Answer: Yes, the DBE requirement includes the water and sewer items.

E. Question: Since the completion date for this project is more than 366 calendar days, will DeKalb County include the GDOT Special Provision Specification 109 for the Liquid Index Price Adjustment?

Answer: The Asphalt Indexing does not apply to this project.

F. Question: What is the budget for this project?

Answer: Cost estimates are not made available for projects funded through the Georgia Department of Transportation.

G. Question: We have been unable to find on the plans where it is shown which water lines are to be filled with flowable fill. Can the plans be revised to call out which water lines are to be filled with flowable fill?

Answer: The plans will not be revised. The existing 6” and 8” line from sta 102+33 to sta 117+25 will need to be abandoned and grout filled. Additionally, any lines off the lines noted above shall be grout filled to the plug/cap connections as shown on the drawings.

H. Question: There are several bid items that are associated with one PI and not the other. Due to PI# 0008121 and PI# 0012789 both having a 14% DBE goal, can the following bid items be added to both PI’s in order for the Contractor to spread the money across both PI’s?

- a. Grassing items, erosion control items, and traffic control

Answer: No, the DBE goals need to be based on the items for each PI number (0008121 and 0012789).

I. Question: Will the basis of award for this project be low bidder for the Grand Total Bid? (Grand Total Bid = Total Bid PI 008121 + Total Bid PI 0012789 + Total Bid Water & Sewer)

Answer: Add the following to Bid Document Page 13 Under Award of Contract: The low bid will be determined based on the sum of the grand total bid for PI0008121, PI0012789 and Water & Sewer items.

J. Question: It appears the water & sewer bid items are included with PI# 0008121. Does the DBE goal of 14% for PI# 0008121 include the water & sewer items?

Answer: See response to question “D”.

K. Question: Will the GDOT Asphalt Index apply to this project due to the completion date being greater than 1 year?

Answer: See response to question “E”.

L. Question: According to one of our water subs there was a new water main installed recently from Memorial Drive to N. Deshon. That project skipped over Pine Lake because of this Rockbridge Road project. There are new stub outs on each end of this project that are not reflected on the plans. Should connections to this new water main be incorporated into this project?

Answer: Yes. DeKalb County has recently installed a new 8”waterline on each end of the project. Please refer to the as-builts attached to this addendum. The plugs on the end of the 8” line at each end of the project reflect the approximate location of where the new tie-in is located.

M. Question: Page 22 of the bid documents states “If the Bidder’s Unit Price exceeds one page in length it should be completed in an excel format, typewritten, printed out and attached hereto. Handwritten Unit Prices exceeding one page in length may not be accepted and may result in the proposed Bid being deemed non-responsive.” Please clarify what this statement means. Can the bidder print out the bid form and handwrite the unit prices in the spaces provided? If the County wants an excel bid form filled out please provide one to the bidders.

Answer: Please provide either typewritten or written legibly, printed out and inserted in a separate sealed envelope.

N. Question: There are 3 Business Signs located on parcels 6 & 7 that will need to be removed. Will these signs be removed prior to construction? If not, what responsibility does the Contractor have for relocating these signs?

Answer: No signs are being removed on parcel 7. The signs on parcel 6 shall be removed as a part of the construction contract.

O. Question: There will be existing parking lot pavement removed inside the easements shown on parcels 6 & 7. How will the County pay for the replacement of this pavement once impacted by construction?

Answer: Quantities have been provided for the replacement of the parking lot as shown on the plans. Repair work (if applicable) on this parking lot for parcel 6 and 7 will be paid for by the unit costs established under the contract and must be approved by the engineer to be considered for payment.

P. Question: There is an existing light pole located at approximate sta. 110+75 RT that will need to be removed. Will this light pole be removed prior to construction? If not, what responsibility does the Contractor have for relocating this light pole?

Answer: This light pole will be relocated by Georgia Power as a part of their utility relocations. Georgia Power intends to replace the lighting along the corridor as a part of their relocation plan.

Q. Question: Where does the Type 2 pull box go on this project? It is listed on the LOM on page 27-0002, but I do not see it on the plans.

Answer: Type 2 pull box is not required for this signal. A revised sheet 27-0002 updating the list of materials is attached to this addendum.

R. Question: Since there is one schedule of values for each PI (Two in total), how would like the county to split the lump sum items such as traffic control and grading complete since they are repeated in both?

Answer: Grading complete is the only lump sum quantity on both PI numbers. Please base your grading complete lump sum costs on the roadway items associated with the PI number that it is under. Please refer to the typical sections for the extent of work associated with each PI number.

S. Question: If we are a Prime DBE/LSBE do we need to have include a subcontractor DBE participation to meet the 14% requirements?

Answer: No, additional DBE participation is not required, however, you must include your information on the DBE goal sheet if the Prime is going to meet the DBE requirement.

2. It is the responsibility of each bidder to ensure that he/she is aware of all addenda issued under this RFP. Please sign and return this addendum. You may call Jennifer Schofield, Procurement Agent, 404.687.4042; before the Proposals are due to confirm the number of addenda issued.
3. All other conditions remain in full force and effect.

Jennifer Schofield
Procurement Agent
Department of Purchasing and Contracting

ACKNOWLEDGMENT

Date: _____

The above Addendum #1 is hereby acknowledged:

(NAME OF BIDDER)

(Signature)

(Title)

jjs/DR

***RFP No. 19-101072,
ROAD WIDENING, SIDEWALKS, BIKE LANES (ROCKBRIDGE ROAD - ALLGOOD TO
ROWLAND ROAD)***

DEKALB COUNTY PUBLIC WORKS

PLAN AND PROFILE OF PROPOSED CS 796/ROCKBRIDGE ROAD FROM ALLGOOD ROAD TO ROWLAND ROAD

CSTEE-0008-00(121)

DEKALB COUNTY

FEDERAL ROUTE * N/A

STATE ROUTE * N/A

P.I. NO. 0008121/0012789

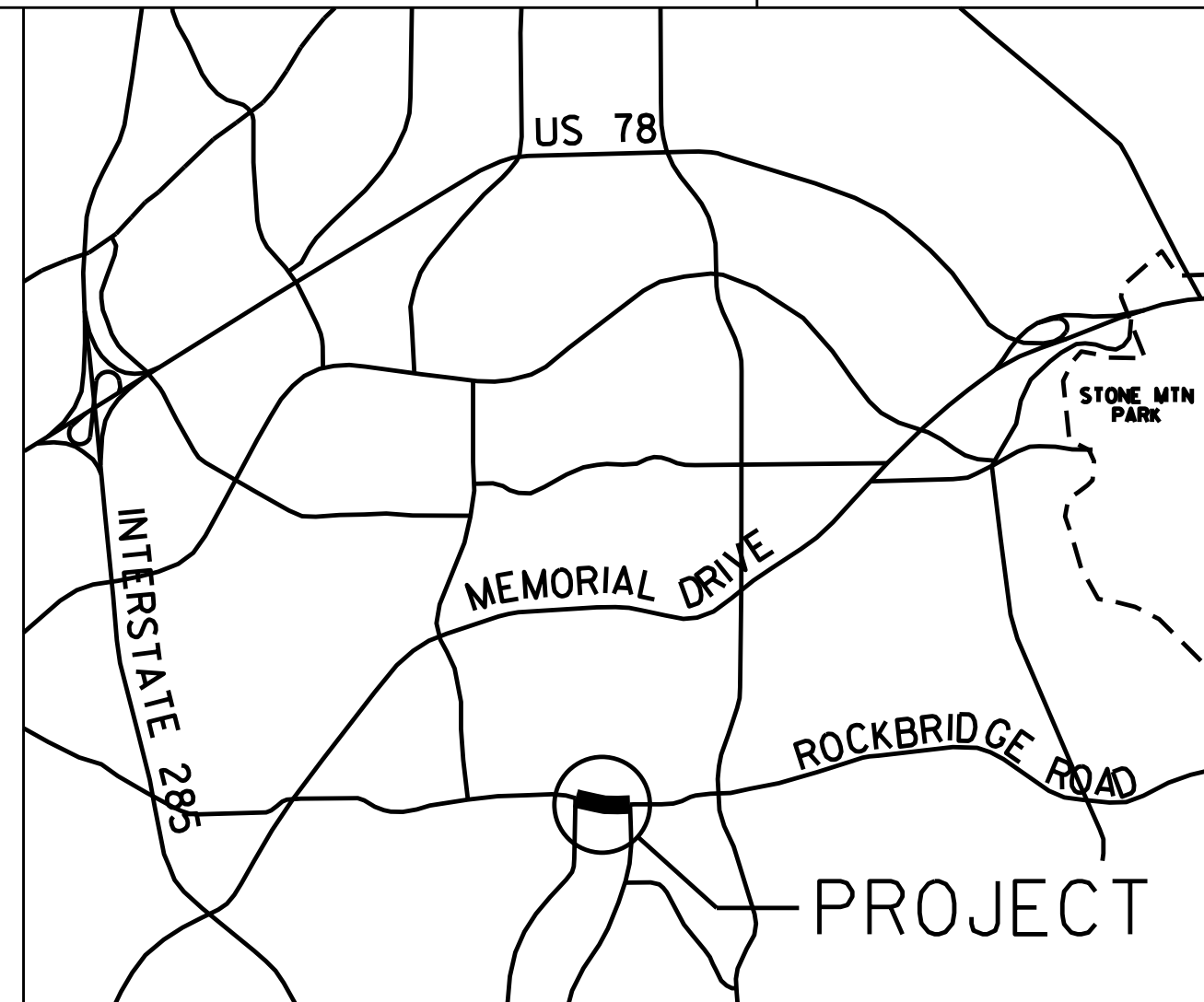

LOCATION SKETCH
N.T.S.

DESIGN DATA: ROCKBRIDGE ROAD
TRAFFIC A.D.T.: 18,920 (2018)
TRAFFIC A.D.T.: 23,000 (2038)
TRAFFIC D.H.V.: 750
DIRECTIONAL DIST: 66%
% TRUCKS: 8.6%
24 HR. TRUCKS %: 7.3%
SPEED DESIGN: 35 MPH

LOCATION & DESIGN
APPROVAL DATE: 3/29/16
FUNCTIONAL CLASS: URBAN MINOR ARTERIAL
PROJECT DESIGNATION: EXEMPT

THIS DOCUMENT HAS BEEN PREPARED
USING THE GEORGIA COORDINATE SYSTEM
OF 1985 WEST ZONE (NAD 83/94) AND
THE NORTH AMERICAN VERTICAL DATUM
OF 1988 (NAVD 88).

THIS PROJECT IS 100% IN DEKALB
COUNTY AND IS 100% IN CONGRESSIONAL
DISTRICT NO. 4.

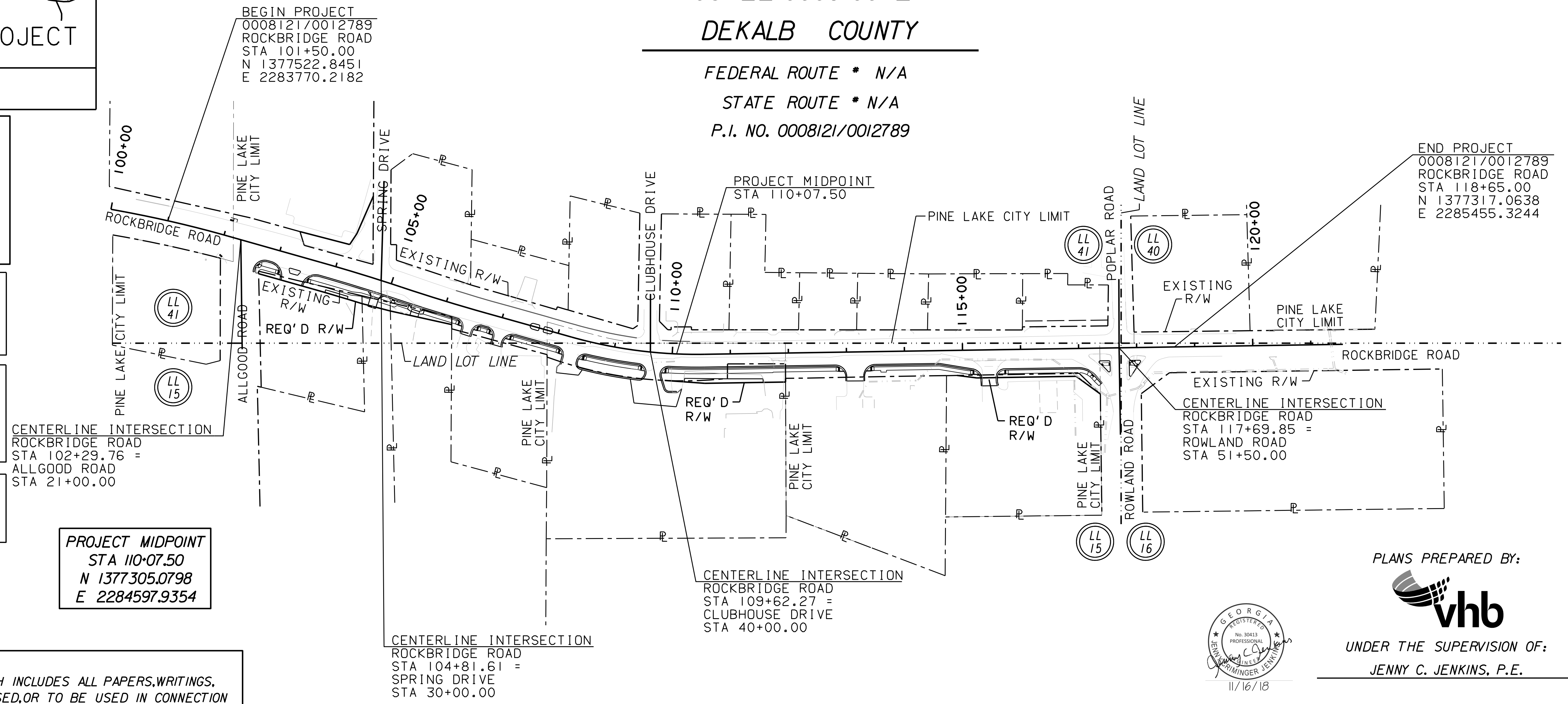

PROJECT MIDPOINT
STA 110+07.50
N 1377305.0798
E 2284597.9354

BEGIN PROJECT
0008121/0012789
ROCKBRIDGE ROAD
STA 101+50.00
N 1377522.8451
E 2283770.2182

END PROJECT
0008121/0012789
ROCKBRIDGE ROAD
STA 118+65.00
N 1377317.0638
E 2285455.3244

NOTE :
ALL REFERENCES IN THIS DOCUMENT, WHICH INCLUDES ALL PAPERS, WRITINGS,
DOCUMENTS, DRAWINGS, OR PHOTOGRAPHS USED, OR TO BE USED IN CONNECTION
WITH THIS DOCUMENT, TO "STATE HIGHWAY DEPARTMENT OF GEORGIA", "STATE
HIGHWAY DEPARTMENT", "GEORGIA STATE HIGHWAY DEPARTMENT", "HIGHWAY
DEPARTMENT", OR "DEPARTMENT" WHEN THE CONTEXT THEREOF MEANS THE
STATE HIGHWAY DEPARTMENT OF GEORGIA, AND SHALL BE DEEMED TO MEAN
THE DEPARTMENT OF TRANSPORTATION.

THE DATA TOGETHER WITH ALL OTHER INFORMATION SHOWN ON THESE PLANS
OR IN ANY WAY INDICATED THEREBY, WHETHER BY DRAWINGS OR NOTES, OR IN
ANY OTHER MANNER, ARE BASED UPON FIELD INVESTIGATIONS AND ARE BELIEVED
TO BE INDICATIVE OF ACTUAL CONDITIONS. HOWEVER, THE SAME ARE SHOWN AS
INFORMATION ONLY, ARE NOT GUARANTEED, AND DO NOT BIND THE DEPARTMENT
OF TRANSPORTATION IN ANY WAY. THE ATTENTION OF BIDDER IS SPECIFICALLY
DIRECTED TO SUBSECTIONS 102.04, 102.05, AND 104.03 OF THE SPECIFICATIONS.

LENGTH OF PROJECT	DeKALB COUNTY No. 089
P.I. NO. 0008121/0012789	MILES
NET LENGTH OF ROADWAY	0.325
NET LENGTH OF BRIDGES	0.000
NET LENGTH OF PROJECT	0.325
NET LENGTH OF EXCEPTIONS	0.000
GROSS LENGTH OF PROJECT	0.325

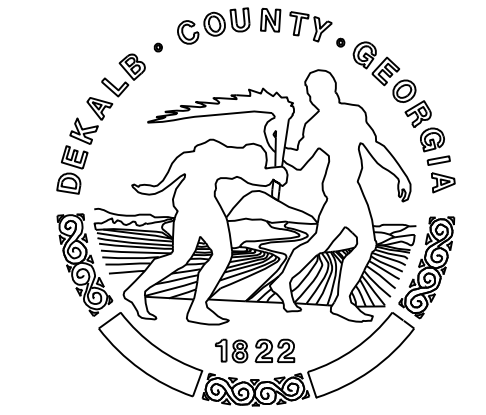

PLANS PREPARED BY:
vhb
UNDER THE SUPERVISION OF:
JENNY C. JENKINS, P.E.

PLANS COMPLETED	11/16/18
REVISIONS	
03/07/19 :	01-0001, 03-0001, 27-0002

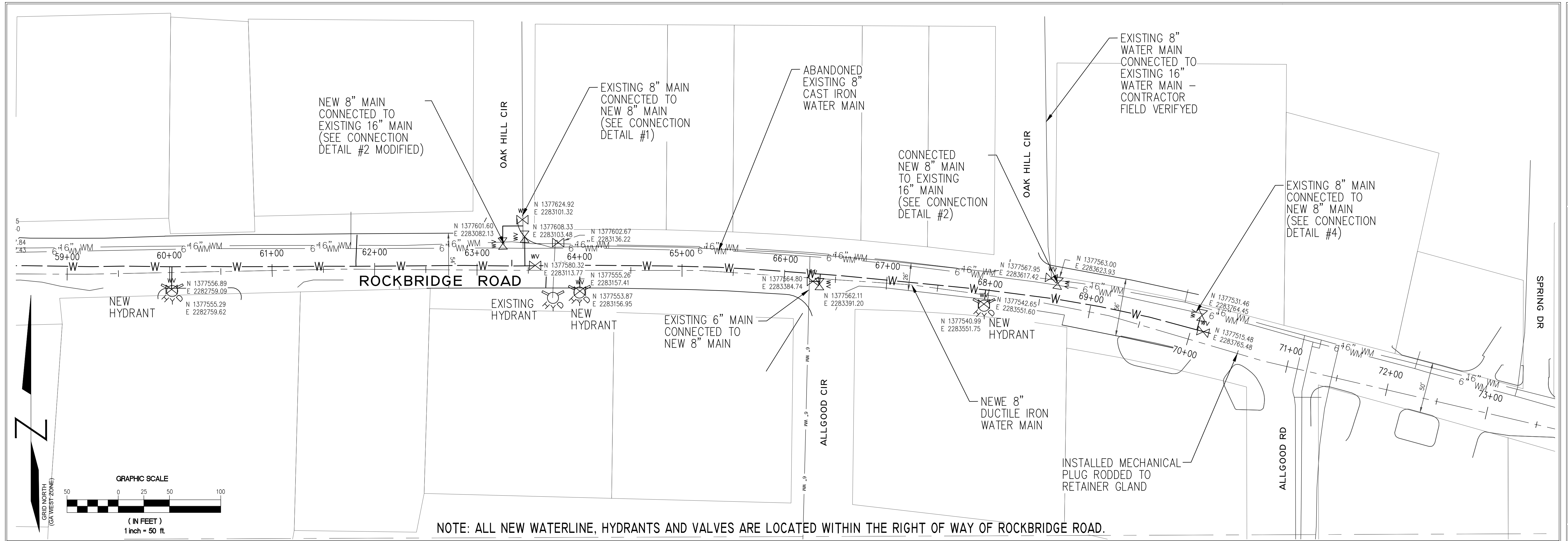

NOTE: ALL NEW WATERLINE, HYDRANTS AND VALVES ARE LOCATED WITHIN THE RIGHT OF WAY OF ROCKBRIDGE ROAD.

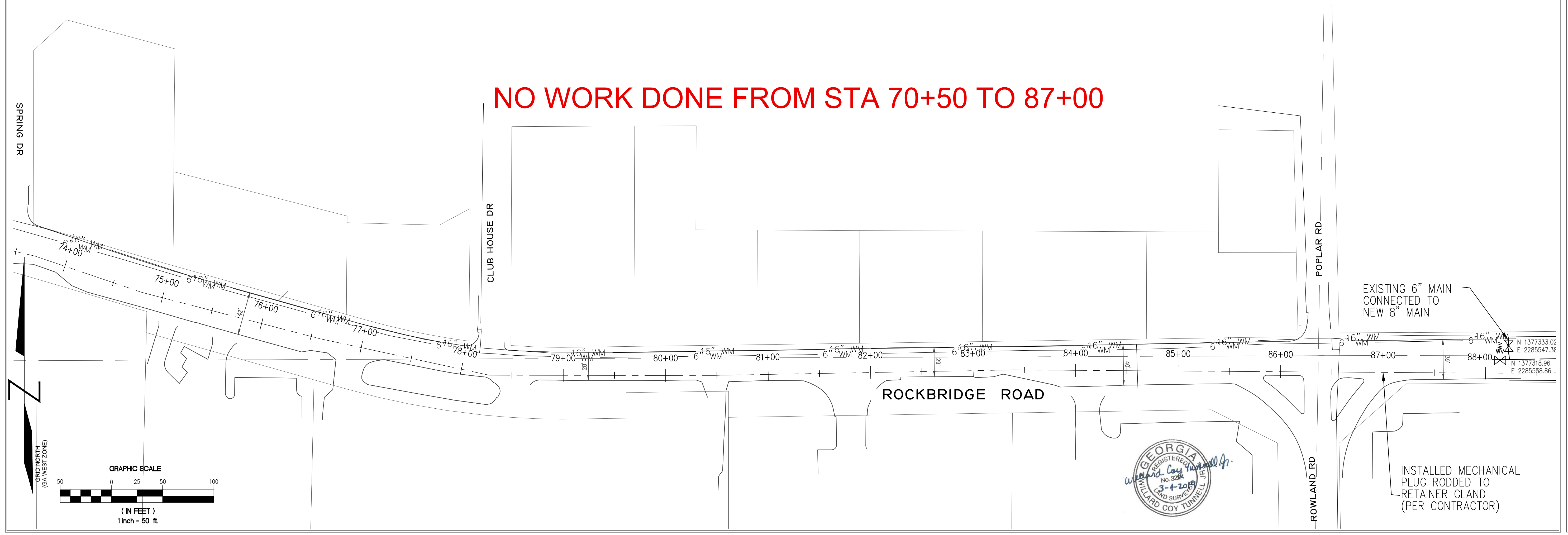

Corporate Environmental Risk Management 1990 Lakeside Parkway ♦ Suite 300 ♦ Tucker GA 30084 O: 678.999.0173 ♦ F: 678.999.0186 www.cerm.com	
PROJECT: ROCKBRIDGE ROAD SOUTH INDIAN CREEK ROAD TO SOUTH HAIRSTON ROAD AC WATER MAIN REPLACEMENT PROJECT DEKALB COUNTY, GEORGIA	
CLIENT: REEVES + YOUNG CONTACT: JESSICA FOMLER	
PROJ. NO.: 2017-1358-004 DATE: 1/8/2019 SCALE: 1"=50' DRAWN BY: DGK CHECKED BY: WCT	
SHEET TITLE AS-BUILT SURVEY	
SHEET NO. 4 OF 6	

NO.	DATE	DESCRIPTION
1.	2-4-19	REVISED PER CLIENT COMMENTS
2.	2-26-19	REVISIONS PER OWNER COMMENTS

LED COUNTDOWN PED HEAD

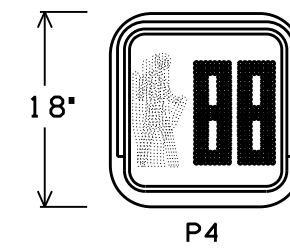

PEDESTRIAN SIGN

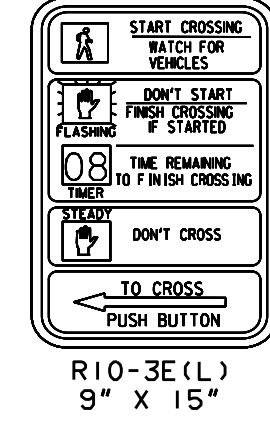

LIST OF MATERIALS

MATERIALS	UNIT	QUANTITY
LOOP/PED LEAD-IN WIRE (SHIELDED, TWISTED/1000 FT); 3 PAIR, 18 AWG	REEL	1
SIGNAL CABLE (14 AWG); 7 CONDUCTOR, PER 1000 FT.	REEL	1
1-SECTION, 16" x 18" LED - "INCANDESCENT LOOK" COUNTDOWN PEDESTRIAN SIGNAL HEAD, FULL HAND/MAN OVERLAP 9" HIGH, NUMBERS & 12" SYMBOLS	EA	1
PEDESTRIAN PUSHBUTTONS STATIONS, W/BUTTONS AND SIGNS: 9" x 15", R10-3E(L) LEFT OR (R) RIGHT, COUNTDOWN	EA	1
HARDWARE FOR PEDESTAL POLE, TOP POST MOUNTING, ONE-WAY BRACKET ASSEMBLY	EA	1
PEDESTAL POLE & SQUARE BASE	EA	1
PULL BOX, PB-3	EA	1
CONDUIT, NONMETAL, TP 2, 1"	LF	10
CONDUIT, NONMETAL, TP 2, 2"	LF	15
MISCELLANEOUS MATERIALS NEEDED TO COMPLETE INSTALLATION	LUMP	LUMP

NOTE: THE LIST OF MATERIALS IS A GUIDE, NOT AN ALL-INCLUSIVE LIST

PAY ITEMS

639-2002	STEEL WIRE STRAND CABLE, 3/8 IN	LF	15
639-4004	STRAIN POLE, TP IV	EA	1
647-1000	TRAFFIC SIGNAL INSTALLATION NO. 1	LUMP	LUMP

NOTE: QUANTITIES ARE FOR INFORMATIONAL PURPOSES ONLY

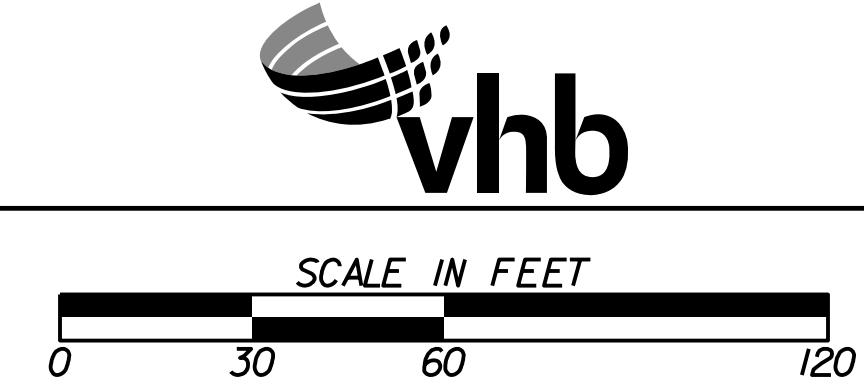
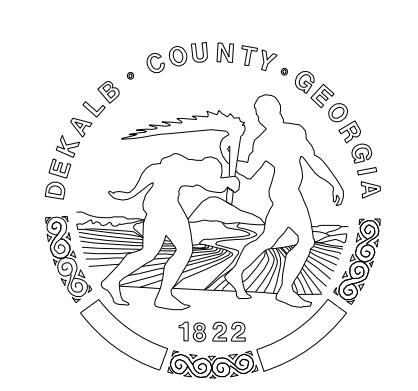
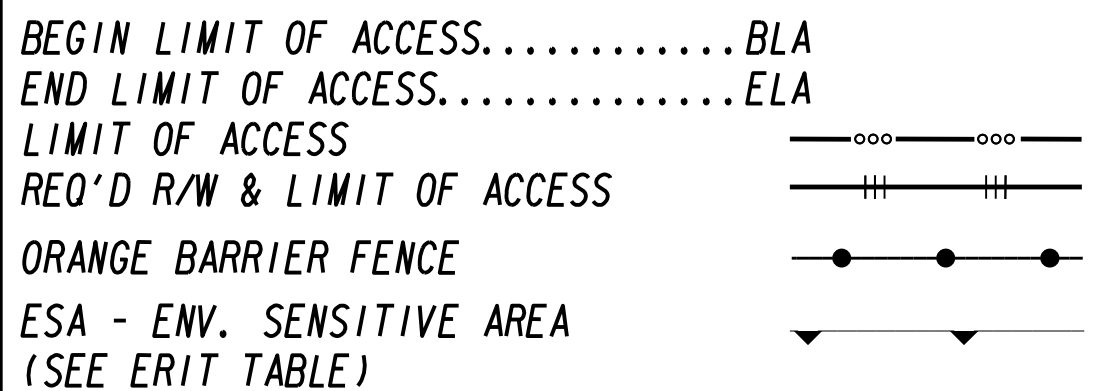
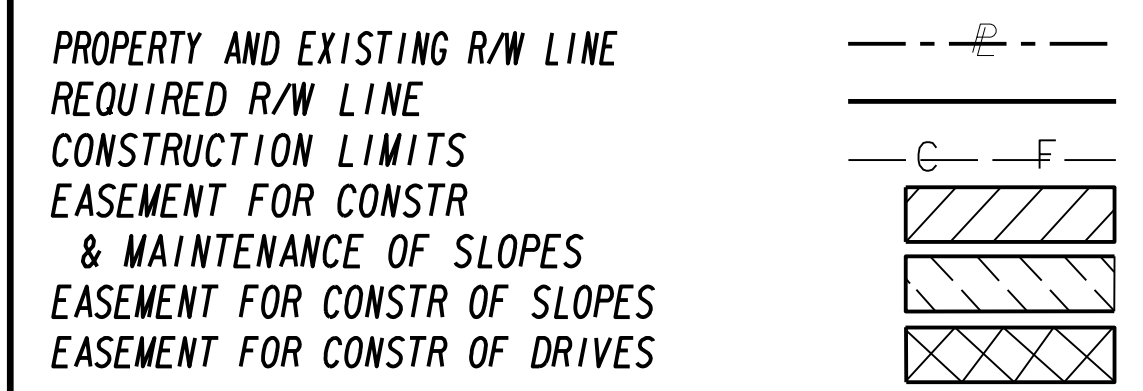
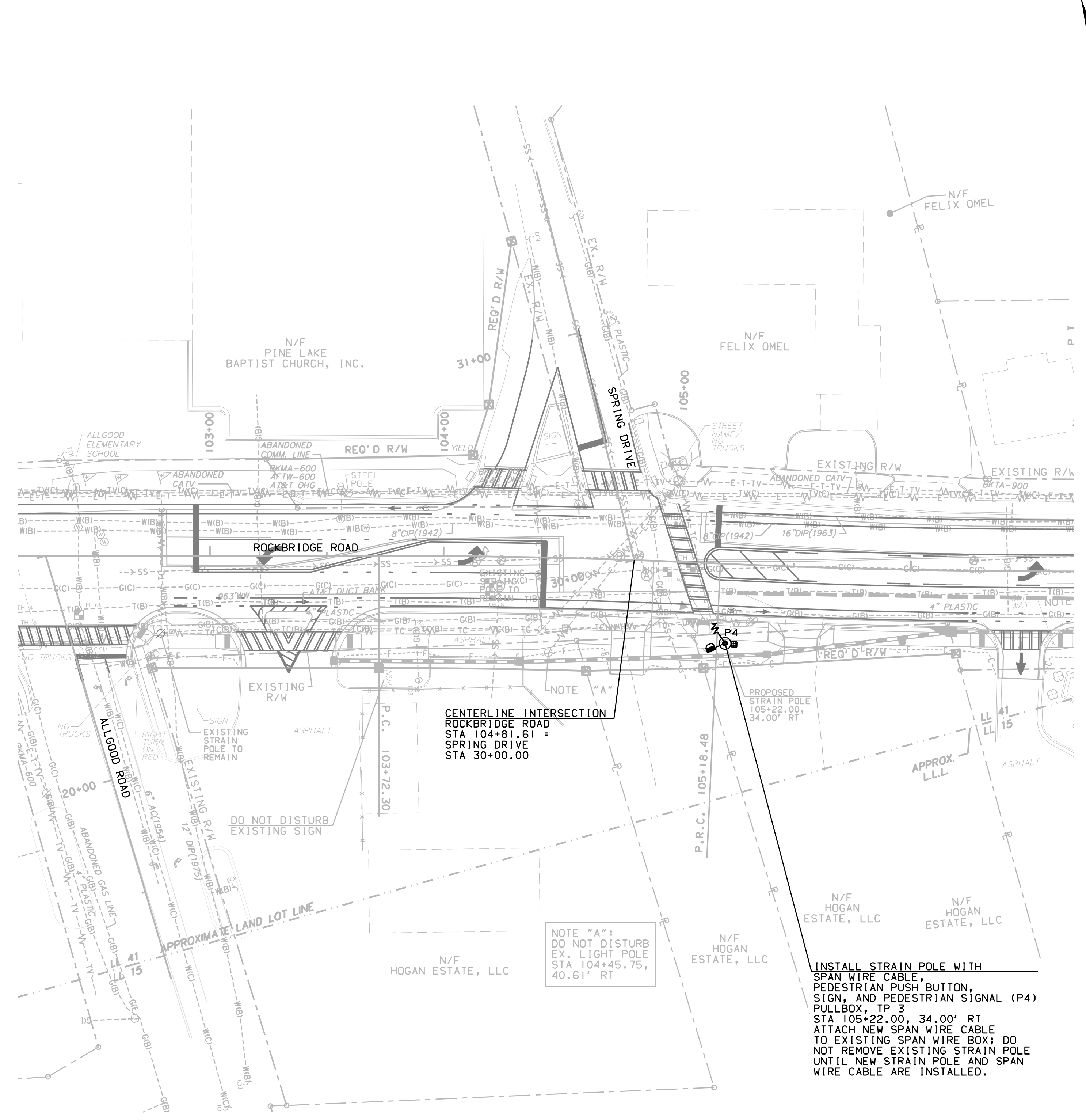

REVISION DATES

DATE	DESCRIPTION
03/07/19	

SIGNAL PLANS

ROCKBRIDGE ROAD
 FROM ALLGOOD ROAD TO ROWLAND ROAD

CHECKED:	DATE:	DRAWING No.
		27-0002
BACKCHECKED:	DATE:	
CORRECTED:	DATE:	
VERIFIED:	DATE:	