



RECEIVED
By Rachel Bragg at 10:01 am, Jun 21, 2021

404.371.2155 (o)
404.371.4556 (f)
DeKalbCountyGa.gov

Clark Harrison Building
330 W. Ponce de Leon Ave
Decatur, GA 30030

Chief Executive Officer
Michael Thurmond

DEPARTMENT OF PLANNING & SUSTAINABILITY

Director
Andrew A. Baker, AICP

Application for Certificate of Appropriateness

Date Received: _____ Application No.: _____

Address of Subject Property: 1635 North Decatur Road, Atlanta Georgia 30307

Applicant: James R. Johnson E-Mail: james.johnson@emory.edu

Applicant Mailing Address: 301 FM Drive, Atlanta Georgia 30322

Applicant Phone(s): 404-210-6636 Fax: 404-727-2127

Applicant's relationship to the owner: Owner Architect: Contractor/Builder Other

Owner(s): Emory University E-Mail: _____

_____ E-Mail: _____

Owner(s) Mailing Address: 1599 Clifton Road, Atlanta Georgia 30322

Owner(s) Telephone Number: 404-210-6636

Approximate age or date of construction of the primary structure on the property and any secondary structures affected by this project: Main House - circa 1923 Auxillary Structure - circa 1960

Nature of work (check all that apply):

- New construction Demolition Addition Moving a building Other building changes
- New accessory building Landscaping Fence/Wall Other environmental changes
- Sign installation or replacement Other

Description of Work:

Remove existing shingle roof, gutters and downspouts from house and auxillary building and install new shingle roof, flashing, metal gutters and downspouts. Proposed shingles to match color of shingles on adjacent houses. Proposed gutters and downspouts to match existing.

This form must be completed in its entirety and be accompanied by supporting documents, such as plans, list of materials, color samples, photographs, etc. All documents should be in PDF format, except for photographs, which may be in JPEG format. Email the application and supporting material to plansustain@dekalbcountyga.gov An incomplete application will not be accepted.

James Johnson
Signature of Applicant/Date

1635 N DECATUR RD Ariel View

Write a description for your map.

Legend

- 📍 1635 N Decatur Rd

📍 1635 N Decatur Rd

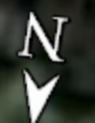



Emory University 1635 North Decatur Road Atlanta 30322

SCOPE OF WORK

- 1) Remove existing shingles, underlayment, and flashings to substrate.
- 2) Replace and replaced any deteriorated wood components per unit prices.
- 3) Install ½” CDX plywood over the existing plank decking. Attach plywood per FMG LPSD 1-29.
- 4) Install self-adhering underlayment over all areas. Install a second layer in the valleys.
- 5) Install new gutter and downspouts. Reuse existing corrugated plastic pipe.
- 6) Install new dimensional shingles.
- 7) Install pre-finished metal drip edge, rake edges, counterflashing, apron flashings and valley liner.
- 8) Install new galvanized steel step flashing and heater vent flashing.
 - a) Paint heater vent flashings
- 9) Install new lead soil stack flashing and paint exposed lead.
- 10) Cut opening and install ridge vents
- 11) Flash all other penetrations per standard details used on other projects.
- 12) Provide a five-year installer warranty and a 30-year shingle manufacturer’s warranty.



Emory University 1635 North Decatur Road Atlanta 30322

ITEMIZED MATERIAL LIST

- 35 squares GAF Timberline Charcoal Architectural Shingles
- 22 rolls Carlisle WIP 300
- 3 bundles starter shingles
- 5 bundles GAF Charcoal 3 tabs
- 20 pieces ridge cap
- 1 pail roofing cement
- 115 -4x8 sheets 1/2" CDX

Timberline® NS Shingles

Select from subtle, even tones and a natural wood-shake look in an asphalt shingle. gaf.com/NS



Weathered Wood



Parkwood



Shakewood



Stone



Weathered Wood



Charcoal



Hickory



Powder Gray



¹StainGuard® algae protection is available only on shingles sold in packages bearing the StainGuard® logo. Products with StainGuard® algae protection are covered by a 10-year limited warranty against blue-green algae discoloration. See *GAF Shingle & Accessory Limited Warranty* for complete coverage and restrictions.

Note: It is difficult to reproduce the color clarity and actual color blends of these products. Before selecting your color, please ask to see several full-size shingles.

CONSTRUCTION DETAILS FOR 'GAF ASPHALT SHINGLE ROOFING SYSTEM'

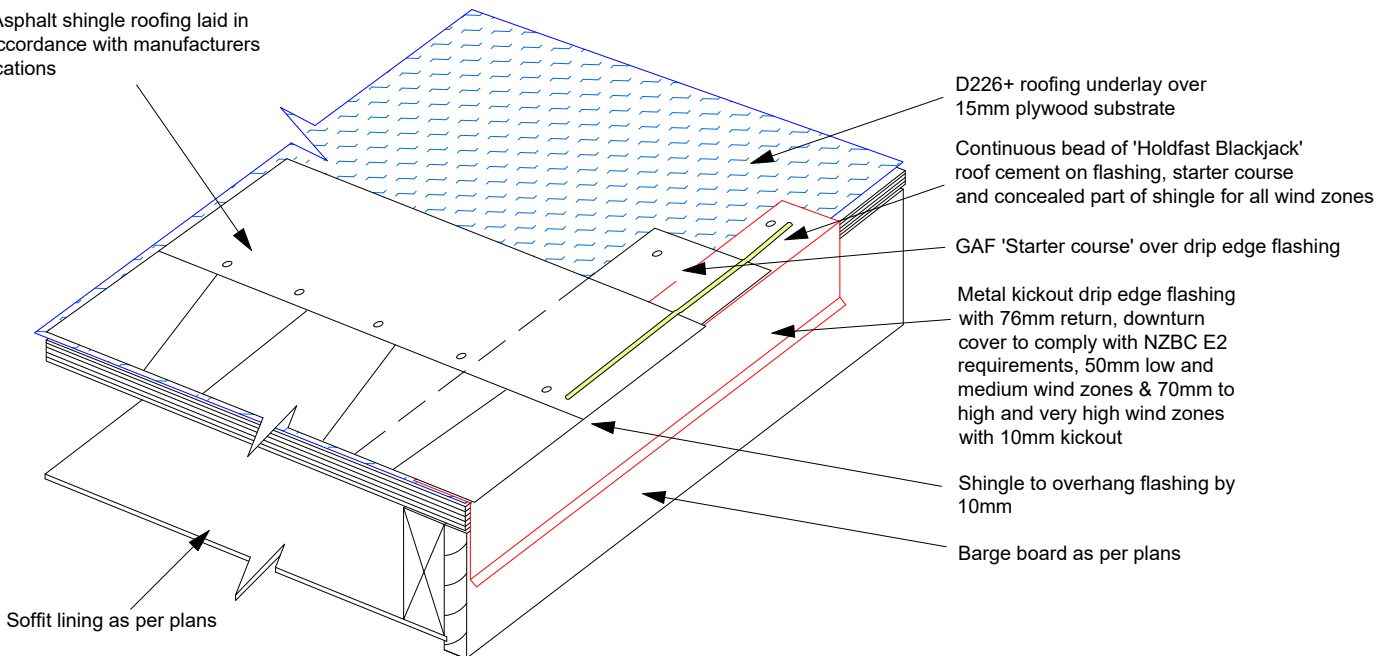
'GAF' Asphalt shingle roofing laid in strict accordance with manufacturers specifications



	DRAWING: BARGE END DETAIL	DATE: 24 JUNE 2018	DETAIL: 13	
	DETAILS FOR: ASPHALT SHINGLE ROOFING	SCALE: N/A		