

December 13, 2019

TO: All Bidders under Invitation to Bid (ITB) No. 19-101196
FROM: Department of Purchasing and Contracting, DeKalb County, Georgia

ADDENDUM NO. 1

Invitation to Bid (ITB) No. 19-101196, Zonolite Park Boardwalk is hereby amended as follows and all documents are incorporated herein by reference:

1. Replace the current pages 21 and 22 (Appendix A & B) with the attached Appendix A & B.
2. Page 1 of the ITB – Deadline for Submission of Questions is corrected to January 3, 2020.
3. The Bid Opening date remains as January 22, 2020 at 3:00 p.m. ET
4. It is the responsibility of each Bidder to ensure that he or she is aware of all addenda issued under this ITB.
5. Please sign and return this addendum with your bid submittal. You may call Beverly D. Williams, Sr. Procurement Agent, at 404-371-3648 before the bids are due to confirm the number of addenda issued.
6. All other conditions remain in full force and effect.

Beverly D. Williams, Sr. Procurement Agent
Department of Purchasing and Contracting

ACKNOWLEDGMENT:

Date: _____

(Company Name)

(Printed Name of Bidder's Authorized Signer)

(Signature of Bidder's Authorized Signer)

(Title)

bdw: PH



THIS DRAWING IS THE PROPERTY OF INTEGRATED LAND DESIGN, LLC AND IS NOT TO BE REPRODUCED OR COPIED IN WHOLE OR IN PART. IT IS ONLY TO BE USED FOR THE PROJECT AND SITE SPECIFICALLY IDENTIFIED HEREIN AND IS NOT TO BE USED IN ANY OTHER PROJECT.



GSWCC LEVEL 1A/LEVEL II CERTIFIED PROFESSIONAL CERTIFICATION #68417

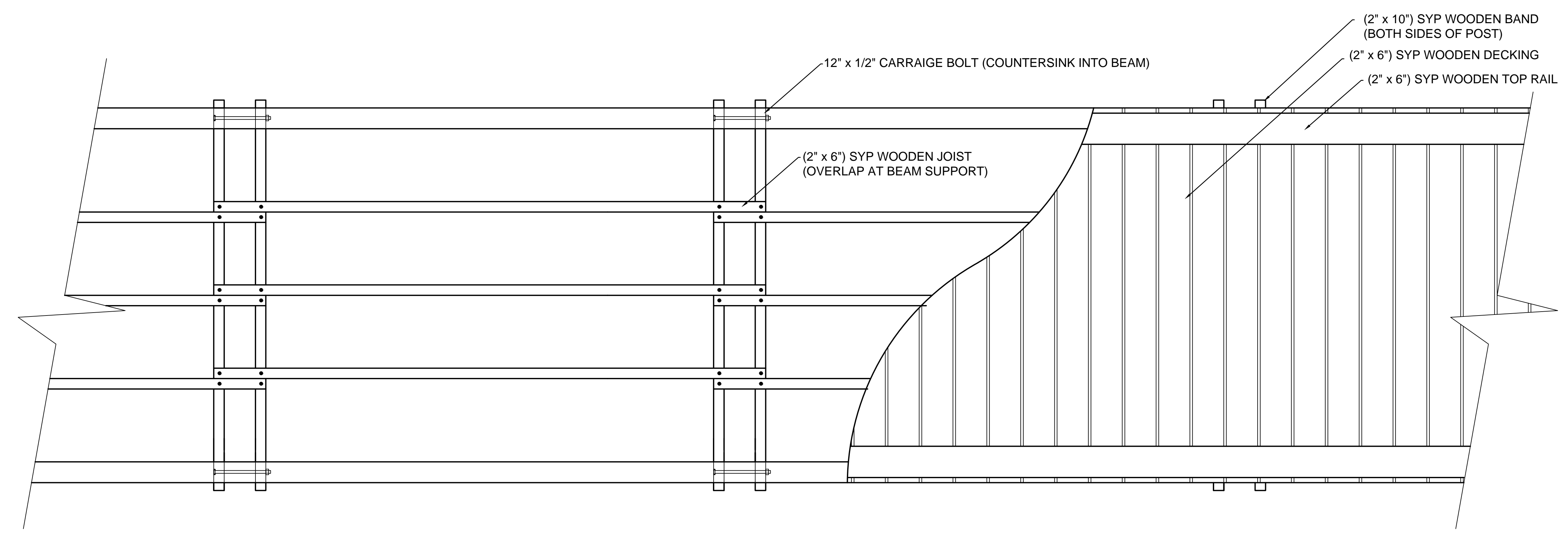

BOARDWALK: SIDE ELEVATION
SCALE: 1/2" = 1'-0"

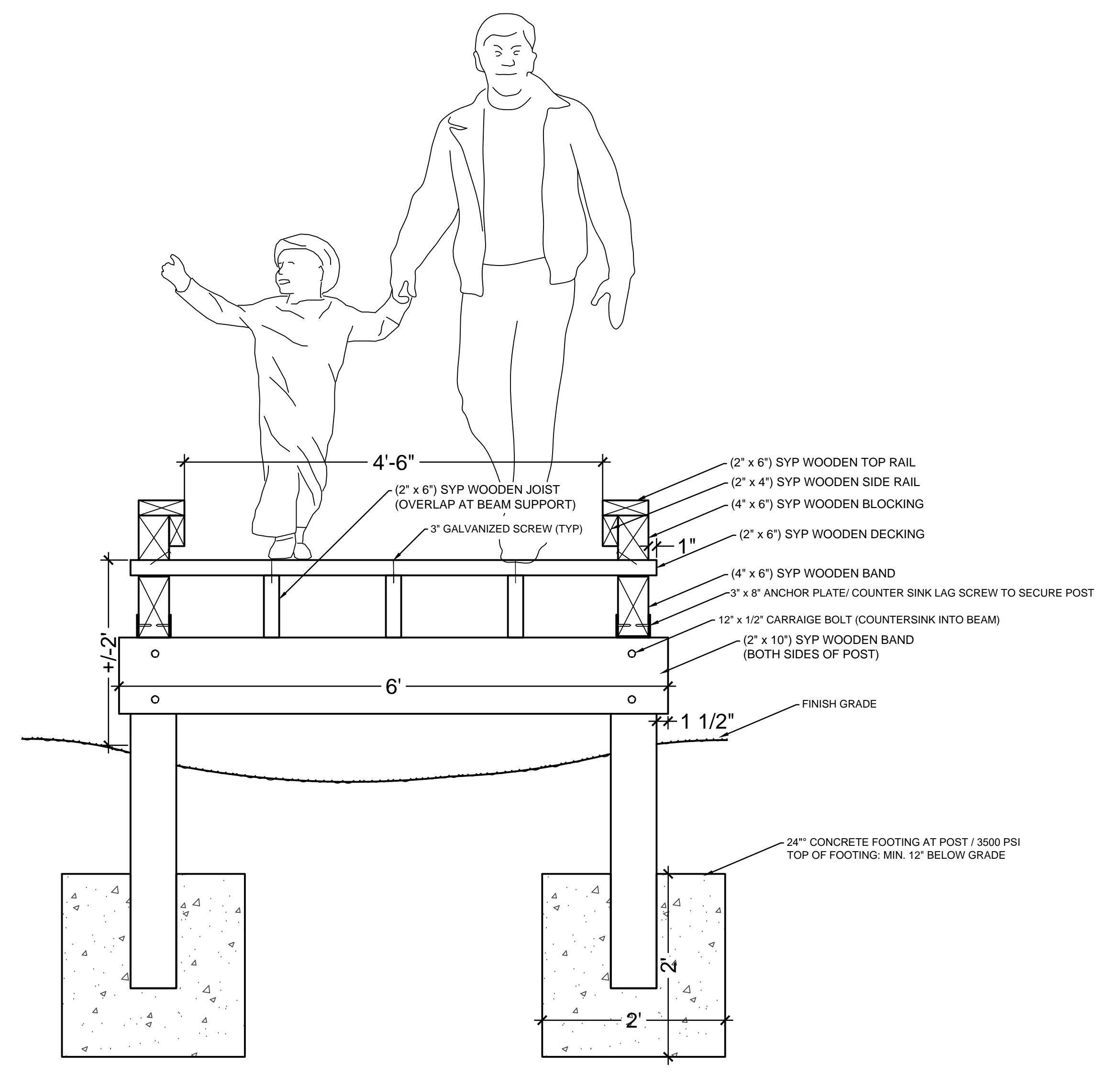

BOARDWALK: SECTION
SCALE: 1" = 1'-0"

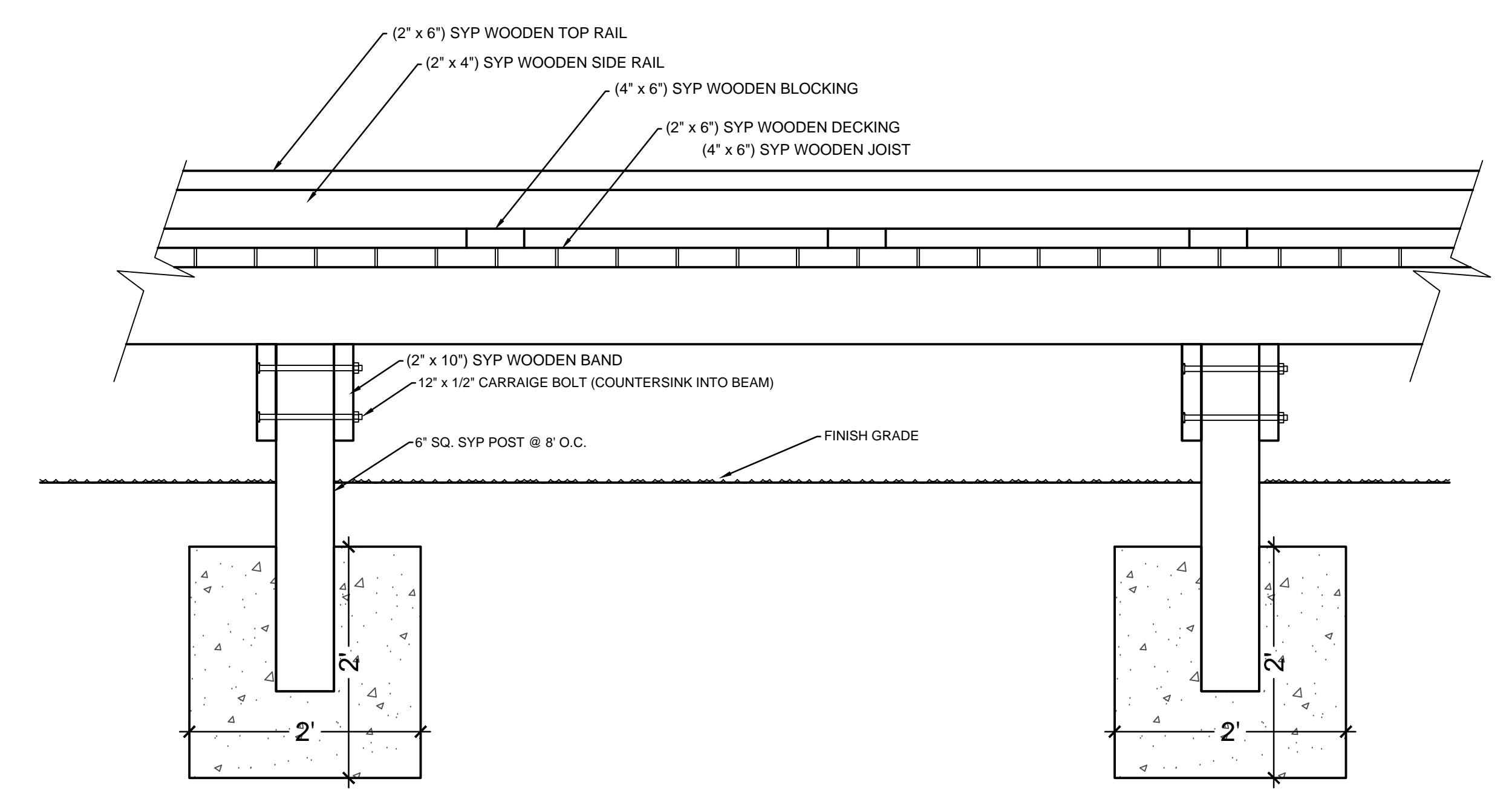

BOARDWALK: SIDE ELEVATION
SCALE: 1" = 1'-0"

SCHEMATIC BOARDWALK DETAILS

ZONOLITE PARK
ZONOLITE RD NE
ATLANTA, GA 30306
DEKALB COUNTY, STATE OF GEORGIA

SHEET: C200
PROJECT NO: 1239
CAD FILE :
DRAWN BY: PH
CHECKED BY: PD
DATE: 09-07-18
REVISIONS:

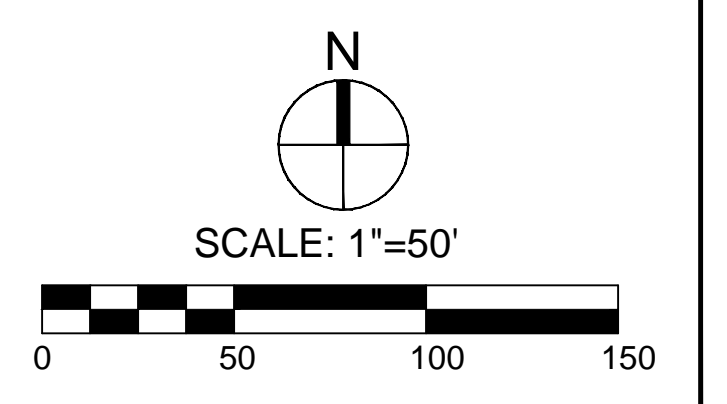



THIS DRAWING IS THE PROPERTY OF INTEGRATED LAND DESIGN, LLC AND IS NOT TO BE REPRODUCED OR COPIED IN WHOLE OR IN PART. IT IS ONLY TO BE USED FOR THE PROJECT AND SITE SPECIFICALLY IDENTIFIED HEREIN AND IS NOT TO BE USED IN ANY OTHER PROJECT.



GSWCC LEVEL 1A/LEVEL II CERTIFIED PROFESSIONAL CERTIFICATION #68417

SCHEMATIC BOARDWALK LAYOUT

ZONOLITE PARK
ZONOLITE RD NE
ATLANTA, GA 30306

DEKALB COUNTY, STATE OF GEORGIA

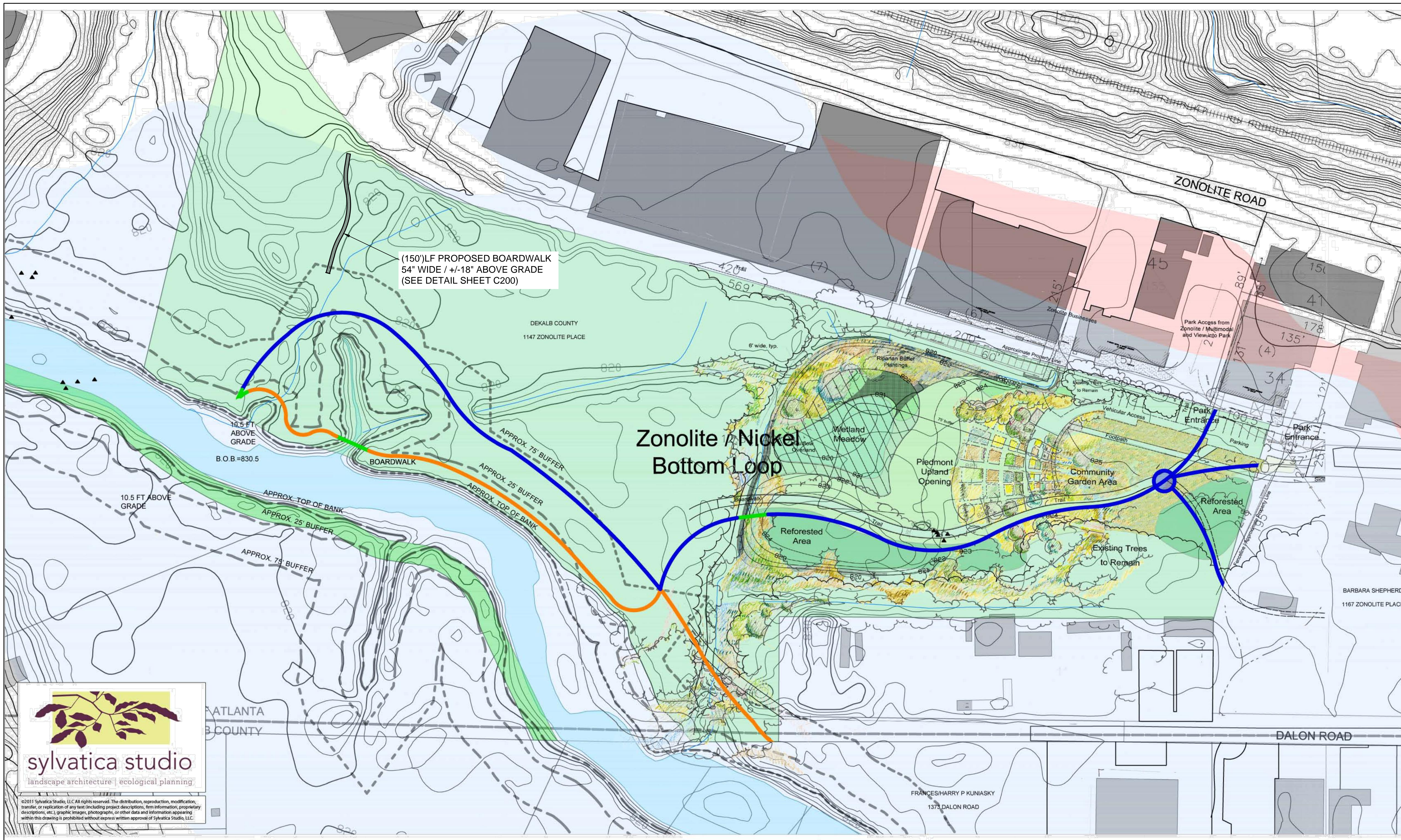

©2011 Sylvatica Studio, LLC All rights reserved. The distribution, reproduction, modification, transfer, or replication of any text (including project descriptions, firm information, proprietary descriptions, etc.), graphic images, photographs, or other data and information appearing within this drawing is prohibited without express written approval of Sylvatica Studio, LLC.

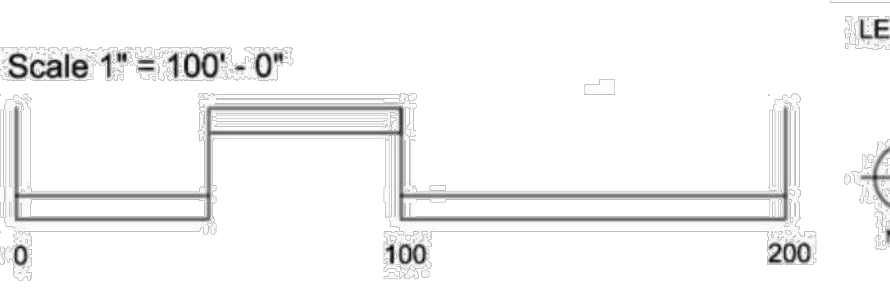

LEGEND

	SFC Primary Trail Corridor Route		Manhole		Headwall
	SFC Alternate Trail Corridor Route		Power Pole		Overlook
	Crossing, Boardwalk, or Special Condition		Picture Location		Tree
	Existing Nature Trail				

Trail Corridor Layout Plan
Confluence and Muscogee Trails
South Fork Conservancy
September 10, 2012 - DRAFT

GIS DATA RESOURCES

Fulton County:	DeKalb County:
Parcels: 2008 City of Atlanta GIS Planning Department (2008 Tax Digest)	Parcels: 2012 DeKalb County GIS Department
Contours: 2009 City of Atlanta GIS Planning Department	Contours: 2012 DeKalb County GIS Department
Floodplains: 2009 Atlanta Regional Commission	Floodplains: 2009 Atlanta Regional Commission
Buildings: 2005 City of Atlanta GIS Planning Department	Buildings: 2007 DeKalb County GIS Department
Aerial: 2010 Microsoft Corporation - Bing	Aerial: 2010 Microsoft Corporation - Bing

SHEET: C100
PROJECT NO: 1239
CAD FILE:
DRAWN BY: PH
CHECKED BY: PD
DATE: 09-07-18
REVISIONS:

